



RESONANCE

Music, Industry, Education... In Sync

PROSPECTUS

www.resonance-edu.org

**APPLY NOW
FOR SEPTEMBER**

YOUR JOURNEY TO A CAREER IN MUSIC STARTS HERE

Study at the brand-new contemporary music institute that's run by the industry, for the industry.

www.resonance-edu.org

All information in this prospectus is correct at the time of writing and is subject to alteration without notice.

CONTENTS

Introduction	2
Degree Courses	6
BMus (Hons) Popular Music Performance	8
BA (Hons) Popular Music Performance & Production	14
BSc (Hons) Popular Music Production	20
Professional Certificate	26
Quals Plus	28
Fees	30
Funding	31
How to Apply	32
Auditions	33
Life at Resonance	34
The Campus	35
Community	35
Where to Live	37
Support	37
Union Membership	37
Equality and Diversity	39
Disability and Accessibility	39
English Language	39
Open Days	40
Who's Behind Resonance	42
Supported by	42
Partners	43

YOU'RE UNIQUE. SO IS RESONANCE.

Resonance isn't your usual higher education provider.

It has been created for the music industry, by the music industry, and by people who understand the transformational power of music and how it can unlock the potential in almost anyone.

We want to help develop musicians, composers, educators and creative practitioners, free in spirit to explore new ideas with confidence and determination.

We want our graduates to be more employable, entrepreneurial, and better-prepared for a career in music than they would be anywhere else.

Our aim is to provide a life-changing experience for our students, that sees them leave us work-ready, unafraid of exploring new ideas and 'having a go'.

What's the difference?

Real life isn't an exam.

The majority of people working in the music sector are freelancers and entrepreneurs managing complex portfolio careers. At Resonance, we provide an educational experience which reflects and supports this reality.

This means you'll work to industry-designed projects providing actual commercial challenges and opportunities. You'll learn how to manage multiple tasks, work as a team, and build your inner resilience.

We will stretch your musical skills and introduce you to new challenges and opportunities. You'll broaden your horizons and acquire those essential 'hard' and 'soft' skills needed for success in this dynamic, fast-moving world.

The Resonance Professional Certificate, which runs alongside your core degree, focuses on the basic skills, knowledge and understanding essential for a wide range of different roles. It encourages you to develop the right mindset and habits for success in the music industry.

Who do we think we are?

Resonance is a not-for profit organisation. All our income from fees and commercial activities is invested in teaching and learning, and in providing the best possible experience for our students.

We've worked with some of the biggest names in the industry, including Roland, Marshall and Focusrite amongst others, to shape a pioneering programme that blends vocational learning with academic rigour and research.

Who cares, wins

Studying for a degree is a big deal.

It's a major change in anyone's life, especially if you're leaving home and moving to a new area.

So supporting students' emotional health isn't an add-on for us. It's central to our philosophy and runs like a thread through the curriculum, with bespoke training to help you understand and emotionally support yourself and others.

As far as we are aware, no other higher education provider provides this level of care. Just one more reason why Resonance isn't your 'usual' university.

DEGREE COURSES





POPULAR MUSIC PERFORMANCE BMus (Hons)

Looking to start a career as a performer, songwriter or session musician?
The Resonance BMus (Hons) Popular Music Performance programme combines practical and vocational learning with an in-depth study of the music industry.

Page 8



POPULAR MUSIC PERFORMANCE & PRODUCTION BA (Hons)

Are you interested in a career as a performer, songwriter or producer?
Would you like to be involved in artist development?
The Resonance BA (Hons) Popular Music Performance and Production combines creativity and technical learning with an in-depth study of the music industry.

Page 14



POPULAR MUSIC PRODUCTION BSc (Hons)

Keen on a career in live or studio production? The Resonance BSc (Hons) Popular Music Production combines technical learning with an in-depth study of the history, context and theory behind contemporary music production.

Page 20

POPULAR MUSIC PERFORMANCE

BMus (Hons)

Qualification	BMus (Hons)
Course Duration	3 Years
Entry Requirements	See website
Study Mode	Full time
Start Date	September
Validated by	Solent University



**Looking to start a career as a performer, songwriter or session musician?
The Resonance BMus (Hons) Popular Music Performance programme
combines practical and vocational learning with an in-depth study of the
music industry.**

Our Popular Music Performance programme teaches students a range of skills balanced with academic, research and critical-thinking proficiencies that are relevant to many different careers.

The course features extensive study of the music industries including copyright, contract law and career pathways. Students will also develop transferable skills in research, IT, presentation, teamwork, creative thinking, communication skills and project management (see the Resonance Professional Certificate).

Beyond timetabled seminars and workshops, students will be encouraged to engage with the Black Country music scene and our in-house commercial radio station – Black Country Radio. By promoting and performing your own shows, you will have the opportunity to cultivate your talents and expand your understanding of the real-world entertainment industry.

Optional projects and modules in years 2 and 3 will help inform future career options and ensure that technical and musical skills are underpinned by a solid understanding of the wider music industry.

This course will involve practical projects designed in partnership with industry.

The course will be delivered through a combination of interactive lectures, seminars, masterclasses, tutorials, workshops and guest presentations.

Assessment methods include practical assessments, essays, individual reports, final portfolio, individual and group presentations, and final performance.

YEAR 1

YEAR 1 (Level 4)

Individual Performance 1

Core

This module forms the core of your practice as a musician and performer. It contains your weekly instrumental/vocal lesson with a specialist tutor, a weekly lecture on developing yourself as an artist, and structured practice time to hone your skills.

Live Performance 1

Core

Where Individual Performance 1 focuses on your personal practice, this module concentrates on performing with others. You will take part in regular workshops with set repertoire, and work in a band towards an assessed gig.

Creative Music Industries

Core

Key aspects of creativity, from songwriting and promotion, through to audiences and consumption are discussed and explained to enable you to understand the demands of the music industries.

Recital and Instrumental Skills 1

Core

Alongside Individual Performance 1 this module forms the core of your practice as a musician and performer. It contains your weekly instrumental/vocal lesson with a specialist tutor, a weekly lecture on developing yourself as an artist, and structured practice time to hone your skills.

Theory and Listening Skills

Core

This module will help you develop the language to communicate musical ideas. In addition to traditional notation you will learn how to describe and analyse songs and musical productions. All content will be focused on popular music; everything you learn may be applicable at some point in your future musical career.

Studio Performance 1

Core

This module examines how studio work differs from live performance, and how to gain confidence and skills as a creative performer in the studio environment.

YEAR 2

YEAR 2 (Level 5)

Individual Performance 2

Core

This module forms the core of your practice as a musician and performer. It contains your weekly instrumental/vocal lesson with a specialist tutor, a weekly lecture on developing yourself as an artist, and structured practice time to hone your skills.

Live Performance 2

Core

Where Individual Performance 2 focuses on your personal practice, this module concentrates on performing with others. You will take part in regular workshops with set repertoire, and work in a band towards an assessed gig.

Music Portfolio Careers

Core

Full time employment opportunities in the music industries are limited, but there is a wealth of options for you to develop an exciting and varied freelance career. This module provides you with opportunities to research these options, develop existing skills and learn new skills in order to begin your personal portfolio career. Expect to begin creating your networks and to start working in the music industries before you finish your studies at Resonance.

Recital and Instrumental Skills 2

Core

Alongside Individual Performance 2 this module forms the core of your practice as a musician and performer. It contains your weekly instrumental/vocal lesson with a specialist tutor, a weekly lecture on developing yourself as an artist, and structured practice time to hone your skills.

Studio Performance 2

Core

This module examines how studio work differs from live performance, and how to gain confidence and skills as a creative performer in the studio environment. This module builds directly upon the skills developed in Studio Performance 1.

Introduction to Experimental Music Performance

Option

You will explore the creative dynamics of existing sound performances and recordings. You will investigate alternative approaches to music making by exploring experimental techniques that draw from creative music practices.

Songwriting Techniques

Option

This module will help you develop and enhance your skills in songwriting and will allow you to develop your musical identities through a wide range of songwriting tasks.

YEAR 3

YEAR 3 (Level 6)

Individual Performance 3

Core

This module forms the core of your practice as a musician and performer. It contains your weekly instrumental/vocal lesson with a specialist tutor, a weekly lecture on developing yourself as an artist, and structured practice time to hone your skills.

Advanced Music Performance

Core

This module builds on all the skills and learning developed in the Live Performance and Studio Performance modules at Levels 4 and 5. Advanced styles of critique, enquiry and analysis are introduced, and the meaning of 'advanced performance' is further unpicked.

Entrepreneurship and Artist Development

Core

As you prepare for life beyond University, it is essential that you continue the alignment of your practical music skills and artistic identity with potential portfolio careers. In order to promote yourself and develop income streams you will need to be fully prepared for high-pressure interviews and auditions. In addition, you will need a professional quality show-reel in order to market yourself. Building on skills developed at Levels 4 and 5 you'll be encouraged to take your expertise to the next level.

Major Project

Core

The ability to produce a significant project underpinned by deep and meaningful research, presented using the correct academic protocols will provide you with essential graduate skills that you will need for future. This project should be interesting, exciting and insightful, and will help you to shape the next stage of your professional or academic life.

Songwriting Portfolio

Option

The ability to write (or co-write) your own material in order to fully realise your artistic voice is paramount. Many of today's major artists, along with a new wave of young skilled songwriters, are providing material across different genres for both emerging artists in addition to more established solo artists and bands.

Experimental Music Performance

Option

You will explore the creative dynamics of existing sound performances and recordings. You will investigate alternative approaches to music making by exploring experimental techniques that draw from creative music practices.

Should you have any questions please email admissions@resonance-edu.org.

FEES

Please see website for fees for the academic year for all UK and Channel Islands students. Additional fees may apply to non-compulsory excursions, tours and extra-curricular activities. Students will be notified of these extra fees in advance. **Please see page 30 for more info.**

HOW TO APPLY

Applications to Resonance are via UCAS (University and Colleges Admissions Service), and our degree courses can be added as one of your UCAS choices when completing your application.

To apply, please visit the Popular Music Performance BMus (Hons) page on the Resonance website. Click APPLY NOW to start the application process. This will take you to the relevant course page on the UCAS website, where you can complete your application.

Once your application has been received, you will be invited to attend an audition and interview, and will be notified of open day dates, events, and other opportunities.

Ideally, your application should reach UCAS by the mid January deadline. Early application is advised for the most popular subject areas. Late applications may be made until the end of June. Applications can be made after the June deadline through the UCAS clearing system. **Please see page 32 for more info.**

KEY ENTRY REQUIREMENTS

- See website for required UCAS tariff points from A-levels or equivalent, including RSL VQ at Level 3 and Rockschoool exams at grade 6 or higher.
- A minimum of two completed A-levels, an RSL/BTEC Extended Diploma or RSL/BTEC Diploma or equivalent, or a combination of qualifications which comply with the minimum UCAS points entry requirements.
- UK applicants will be asked to attend an audition.
- Applicants over the age of 21 may be considered based on relevant experience, without having the required tariff points.

All information in this prospectus is correct at the time of writing and is subject to alteration without notice. Courses or optional modules may not run if student numbers are insufficient to provide a viable and meaningful learning experience. In such circumstances, students will be advised on other available options.



Scan to visit website

POPULAR MUSIC PERFORMANCE AND PRODUCTION

BA (Hons)

Qualification	BA (Hons)
Course Duration	3 Years
Entry Requirements	See website
Study Mode	Full time
Start Date	September
Validated by	Solent University



**Are you interested in a career as a performer, songwriter or producer?
Would you like to be involved in artist development? The Resonance
BA (Hons) Popular Music Performance and Production combines creativity
and technical learning with an in-depth study of the music industry.**

The Popular Music Performance and Production programme offers a broad range of skills in music and production, carefully balanced with academic skills involving research and critical thinking. Students will gain experience both specific to the music industry and relevant to other careers.

The course features extensive study of the music industries including copyright, contract law and career pathways. Students will also develop transferable skills in research, IT, presentation, teamwork, creative thinking, communication skills and project management (see the Resonance Professional Certificate).

The curriculum is delivered by an experienced course team, many of whom are active industry experts with professional experience in performance, studio and live sound, electronic sound design and the business and culture of music production. Tutors frequently engage with ongoing research in music composition, performance and production.

You will be able to tailor this course to your own interests through optional projects and modules in the second and third years. These modules may help to inform future career options and ensure that technical and musical skills are underpinned by a solid understanding of the wider music industry.

This course will involve practical projects designed in partnership with industry.

The course will be delivered through a combination of interactive lectures, seminars, masterclasses, tutorials, workshops and guest presentations.

Assessment methods include practical assessments, essays, individual reports, portfolio, individual and group presentations, and final performance.

YEAR 1

YEAR 1 (Level 4)

Performance Techniques 1

Core

This module focuses on the essentials of performance. In order to progress swiftly as a musician, you must practise and rehearse efficiently. Alongside this, you will develop an understanding of how popular music works in all its forms.

Introduction to Studio Recording 1

Core

A solid understanding of why and how we mix popular music is vital in improving your music production. This module combines practical mixing and recording with the established and proven theories of how multi-track music is made.

Creative Music Industries

Core

The music industry is fiercely competitive; artists and producers need to be committed to their own creativity and innovation in order to be successful. Key aspects of that creativity are discussed to enable you to understand the demands of the music industries.

Creative Performance 1

Core

Building on the knowledge and techniques developed in Performance Techniques 1, this module continues the focus on the essentials of performance with a greater emphasis on instrumental/vocal skills and techniques.

Creative Music Production 1

Core

Having been introduced to fundamental concepts and theory of audio and music production, you now have the opportunity to apply these concepts to creative projects.

Theory and Listening Skills

Core

This module will help you develop the language to communicate musical ideas. In addition to traditional notation you will learn how to describe and analyse songs and musical productions.

YEAR 2

YEAR 2 (Level 5)

Performance Techniques 2

Core

Building on the knowledge and techniques developed at Level 4, this module continues the focus on the essentials of performance with a greater emphasis on reflective practice.

Advanced Studio Recording 1

Core

This module is key in your development of understanding the processes and expectations of creating an engaging, contemporary, commercial mix.

Music Portfolio Careers

Core

This module provides you with opportunities to research employment options, develop existing skills and learn new skills in order to begin your personal portfolio career.

Creative Performance 2

Core

This module continues the focus on the essentials of performance with a greater emphasis on instrumental/ vocal skills and techniques.

Creative Music Production 2

Core

In alignment with workplace practices, arrangement composition and studio performance are integrated into this module. You will be encouraged to work in collaboration with other disciplines in order to broadening your skills and network.

Creative Sound Design

Option

In this module you will expand your musical thinking into the world of film sound design. Whether through music or sound effects, films rely heavily on sound added postproduction; this module gives you the chance to develop skills required for sound in visual media.

Songwriting Techniques

Option

This module will help you develop and enhance your skills in songwriting and will allow you to develop your musical identities through a wide range of songwriting tasks.

YEAR 3

YEAR 3 (Level 6)

Music Collaboration

Core

You will examine how to approach collaborative projects in a manner that suggests professionalism and inspires those around you.

Advanced Music Production

Core

This module allows you the freedom to choose a production technique for an in-depth study, culminating in a demonstration of your advanced skills in a combined audio-visual product.

Major Project

Core

In this module you will undertake a major research project in an area of your choosing. It may take a variety of forms (including a written dissertation, business, or practical project).

Entrepreneurship and Artist Development

Core

You will study and practise prescribed instrumental or vocal techniques and you will be encouraged to develop skills of your choice. In addition, you will learn how to create a show-reel that demonstrates your artistic and technical skills.

Surround Mixing

Option

You will experience recent and emerging technological developments including 5.1 surround sound and Dolby Atmos. The issues in mixing music and film sound will be examined and you will learn how to achieve effective mixes in these formats.

Experimental Music Performance

Option

You will explore the creative dynamics of existing sound performances and recordings. You will investigate alternative approaches to music making by exploring experimental techniques that draw from creative music practices.

Should you have any questions please email admissions@resonance-edu.org.

FEES

Please see website for fees for the academic year for all UK and Channel Islands students. Additional fees may apply to non-compulsory excursions, tours and extra-curricular activities. Students will be notified of these extra fees in advance. **Please see page 30 for more info.**

HOW TO APPLY

Applications to Resonance are via UCAS (University and Colleges Admissions Service), and our degree courses can be added as one of your UCAS choices when completing your application.

To apply, please visit the Popular Music Performance & Production BA (Hons) page on the Resonance website. Click APPLY NOW to start the application process. This will take you to the relevant course page on the UCAS website, where you can complete your application.

Once your application has been received, you will be invited to attend an audition and interview, and will be notified of open day dates, events, and other opportunities.

Ideally, your application should reach UCAS by the mid January deadline. Early application is advised for the most popular subject areas. Late applications may be made until the end of June. Applications can be made after the June deadline through the UCAS clearing system. **Please see page 32 for more info.**

KEY ENTRY REQUIREMENTS

- See website for required UCAS tariff points from A-levels or equivalent, including RSL VQ at Level 3 and Rockschoool exams at grade 6 or higher.
- A minimum of two completed A-levels, an RSL/BTEC Extended Diploma or RSL/BTEC Diploma or equivalent, or a combination of qualifications which comply with the minimum UCAS points entry requirements.
- UK applicants will be asked to attend an audition.
- Applicants over the age of 21 may be considered based on relevant experience, without having the required tariff points.

All information in this prospectus is correct at the time of writing and is subject to alteration without notice. Courses or optional modules may not run if student numbers are insufficient to provide a viable and meaningful learning experience. In such circumstances, students will be advised on other available options.



Scan to visit website

POPULAR MUSIC PRODUCTION

BSc (Hons)

Qualification	BSc (Hons)
Course Duration	3 Years
Entry Requirements	See website
Study Mode	Full time
Start Date	September
Validated by	Solent University



Keen on a career in live or studio production? The Resonance BSc (Hons) Popular Music Production combines technical learning with an in-depth study of the history, context and theory behind contemporary music production.

You will be able to tailor this course to your own interests through optional projects and modules in the second and third years. These modules may help to inform future career options and ensure that technical and musical skills are underpinned by a solid understanding of the wider music industry.

This course will involve practical projects designed in partnership with industry.

The course will be delivered through a combination of interactive lectures, seminars, masterclasses, tutorials, workshops and guest presentations.

Assessment methods include practical assessments, essays, individual reports, portfolio, individual and group presentations, and final performance.

YEAR 1

YEAR 1 (Level 4)

Introduction to Studio Recording 1

Core

A solid understanding of why and how we mix popular music is vital in improving your music production. This module combines practical mixing and recording with the established and proven theories of how multi-track music is made.

Principles of Sound

Core

This module provides a grounding in how sound behaves both acoustically, and when represented by electrical or digital means. An understanding of core concepts introduced here will benefit you in all music and sound related pursuits.

Creative Music Industries

Core

The music industry is fiercely competitive; artists and producers need to be committed to their own creativity and innovation in order to be successful. Key aspects of that creativity, from songwriting and promotion, through to audiences and consumption are discussed and explained to enable you to understand the demands of the music industries.

Principles of Music

Core

Practically all music contains structures and patterns which are readily communicated as a musical language. This module demystifies that language enabling you to understand existing music more deeply, and to communicate musical matters more clearly.

Introduction to Studio Recording 2

Core

You will experience the challenges of recording a full band of musicians. You will also get the chance to continue developing your mixing skills, and to reflect on your project work.

Sampling Synthesis and Midi

Core

Popular music was transformed in both technical and creative ways by the development of electronic instruments, and the MIDI protocol to control them. This module explores some of the fundamental concepts in electronic sound synthesis, and how MIDI relates to the contemporary Digital Audio Workstation.

YEAR 2

YEAR 2 (Level 5)

Advanced Studio Recording 1 Core

This module is key in your development of understanding the processes and expectations of creating an engaging, contemporary, commercial mix. We will explore, through critical analysis, what goes into a modern mix; how cutting-edge processing meets traditional methodologies and techniques in translating a recording to a completed mix down.

Live Music Production Core

The live music sector provides significant employment opportunities in many different areas. In this module you experience the thrill of working in a live event team on your own themed music event in real city venue.

Music Portfolio Careers Core

This module provides you with opportunities to research options for an exciting and varied freelance career and develop existing skills and learn new skills in order to begin your personal portfolio career. Expect to begin creating your networks and to start working in the music industries before you finish your studies at Resonance.

Advanced Studio Recording 2 Core

The complex mix of technical and creative skills makes music production a unique challenge. In this module you will explore how those seemingly different skillsets combine and complement each other.

Creative Sound Design Core

In this module you will expand your musical thinking into the world of film sound design. Whether through music or sound effects, films rely heavily on sound added postproduction; this module gives you the chance to develop skills required for sound in visual media.

Music and Sound for Games Option

Sound design, music and sound effects play a significant part in the overall experience for the end user within the interactive environment of video games. Learning the methodology of working with interactive visual content will lead you to possibilities of employment within the fastest growing industry of games development.

Advanced Live Music Production Option

Taking music to a live audience is essential to the marketing of music productions and the promotion of recording artists. This module explores the advanced elements required for successful live music productions and further explores advanced live music production scenarios.

YEAR 3

YEAR 3 (Level 6)

Advanced Music Production Core

This module allows you the freedom to choose a production technique for an in-depth study, culminating in a demonstration of your advanced skills in a combined audio -visual product.

Live Project Brief Core

Freelance work forms the basis of much of our industry, yet many clients are reluctant to take a chance on new sound engineers or producers. This module helps you get a freelance client as a first step in building your portfolio of clients.

Major project Core

The ability to produce a significant project underpinned by deep and meaningful research, presented using the correct academic protocols will provide you with essential graduate skills that you will need for future.

Live Event Technology Option

The increasing complexity of Live Event systems means that there is a requirement for audio technicians and operators to possess a strong theoretical knowledge and practical ability in the design, assembly, optimisation and operation of lighting systems, sound controllers and other live event technologies.

Surround Mixing Option

As media and entertainment industries push beyond stereo audio, an awareness of the challenges and skills in mixing sound in surround formats will help your understanding and confidence.

Live Sound Technology Option

You will obtain from this module an appreciation of the many factors that need to be accounted for in specifying, configuring and operating professional sound reinforcement systems, and you will be able to select tools and techniques appropriate to a variety of contexts, setups and situations encountered.

Experimental Music Production Option

If you want to challenge the usual habits and conventions in music production, this module will guide and inspire you. The module will explore experimental compositional techniques and processes drawing from avant-garde practices.

Should you have any questions please email admissions@resonance-edu.org.

FEES

Please see website for fees for the academic year for all UK and Channel Islands students. Additional fees may apply to non-compulsory excursions, tours and extra-curricular activities. Students will be notified of these extra fees in advance. **Please see page 30 for more info.**

HOW TO APPLY

Applications to Resonance are via UCAS (University and Colleges Admissions Service), and our degree courses can be added as one of your UCAS choices when completing your application.

To apply, please visit the Popular Music Production BSc (Hons) page on the Resonance website. Click APPLY NOW to start the application process. This will take you to the relevant course page on the UCAS website, where you can complete your application.

Once your application has been received, you will be invited to attend an audition and interview, and will be notified of open day dates, events, and other opportunities.

Ideally, your application should reach UCAS by the mid January deadline. Early application is advised for the most popular subject areas. Late applications may be made until the end of June. Applications can be made after the June deadline through the UCAS clearing system. **Please see page 32 for more info.**

KEY ENTRY REQUIREMENTS

- See website for required UCAS tariff points from A-levels or equivalent, including RSL VQ at Level 3 and Rockschoool exams at grade 6 or higher.
- A minimum of two completed A-levels, an RSL/BTEC Extended Diploma or RSL/BTEC Diploma or equivalent, or a combination of qualifications which comply with the minimum UCAS points entry requirements.
- UK applicants will be asked to attend an audition.
- Applicants over the age of 21 may be considered based on relevant experience, without having the required tariff points.

All information in this prospectus is correct at the time of writing and is subject to alteration without notice. Courses or optional modules may not run if student numbers are insufficient to provide a viable and meaningful learning experience. In such circumstances, students will be advised on other available options.



Scan to visit website

PROFESSIONAL CERTIFICATE

Course Duration
Study Mode
Start Date

3 Years
Runs alongside the degree core programme
September



Developing your employability is more than just having a good degree. During our research phase, employers told us that what they look for when recruiting staff or freelance contractors is a combination of 'hard' skills (music and product specific skills, knowledge and understanding) and 'soft' skills.

Graduates with 'soft' skills are those who:

- work well in teams
- generate innovative ideas
- are confident and proactive
- have a positive 'can do' attitude
- have a range of workplace experiences

Opportunities to develop many of these qualities will exist within your course, but you will also be able to enhance your employability through completing the Resonance Professional Certificate.

Running alongside your core programme, the Professional Certificate gives you a head start as you make your way in the world and helps you explore your career options. Focusing on the basic skills, knowledge and understanding essential for a wide range of different roles, it helps you develop the right attitudes and behaviours for success in the music industry.

The programme is delivered throughout your three years at Resonance via interactive seminars, guest lectures and workshops. A great deal of what you learn on this course will transfer to your main study. Once a year, students will work in teams to resolve a local challenge, e.g. organising a community music festival; producing content for Black Country Radio in raising awareness of a local issue; working with SEND students, and more.

The Professional Certificate will be formatively assessed through a series of workshops, presentations and the submission of a final career plan, which will require students to reflect on their personal and professional development throughout their three years at Resonance. Students are advised to keep a diary, audio or video blog throughout the course to provide a reference point.

QUALS PLUS

Study Mode
Start Date

Runs alongside the degree core programme
September

Students will also be encouraged to participate in our Quals Plus option (at additional cost and subject to availability).

Students will also be encouraged to participate in our Quals Plus option (at additional cost and subject to availability). This involves further study (mostly at Cable Plaza if numbers allow) to gain additional qualifications awarded by external organisations such as RSL (London), PLASA, the Musicians' Union and others. Examples include:

- The RSL's teaching diploma
- The Musicians' Union Certificate for Music Educators (CME)
- The National Rigging Certificate (NRC)
- Electrical safety and management (Plasa)
- First aid at work certificate (FAW)



FEES

The degree courses provided by Resonance are validated by Solent University which is registered with the Office for Students (OfS).

Please see website for fees for the academic year for all UK and Channel Islands students. Additional fees may apply to non-compulsory excursions, tours and extra-curricular activities. Students will be notified of these extra fees in advance.

Resonance offers bursaries and scholarships to assist with the cost of tuition or accommodation, subject to a letter of application. Each bursary or scholarship will be considered by the Board of Trustees.

Additional costs will apply to Qualls Plus courses and will vary according to the assessment process.

Other costs – such as accommodation, books, stationery, instruments, accessories, computers, optional summer school, personal expenses, food, and entertainment – are not included.

Costs also apply to the graduation ceremony, i.e. hiring an academic gown (currently £45) and photography (starting at £15). Full details will be provided at the beginning of the third year of full-time study.



FUNDING

Undergraduate students wishing to study at Resonance are officially registered as Solent University students and are entitled to apply to Student Finance England for support.

Full-time students can apply for tuition fee and maintenance loans. For further details on how to apply, please visit:

- The Government's Student Finance website
- Student Finance England
- Solent University Student Finance Guide



HOW TO APPLY

Applications to Resonance are via UCAS (University and Colleges Admissions Service), and our degree courses can be added as one of your UCAS choices when completing your application.

Our priority is to provide a high-quality admissions experience, offering a bespoke audition and interview process to ensure you receive personalised guidance and support.

To apply, please go to the appropriate course page on the Resonance website, and click **APPLY NOW** to start the application process. This will take you to the relevant course page on the UCAS website, where you can complete your application.

Once your application has been received, you will be invited to attend an audition and interview, and will be notified of open day dates, events, and other opportunities.

If you would like to apply for more than one Resonance course, please add each one as an option on your UCAS application.

Ideally, your application should reach UCAS by the mid January deadline. Early application is advised for the most popular subject areas. Late applications may be made until the end of June. Applications can be made after the June deadline through the UCAS clearing system.

For further assistance, please contact admissions@resonance-edu.org.



AUDITIONS

Resonance is committed to supporting applicants from a wide variety of backgrounds. To reflect this, our admissions policy focuses on performance at audition/interview rather than on academic qualifications alone.

The audition process for all applicants aged 18 and over is designed to reveal your current and potential abilities, and to assess your suitability for the chosen course, and beyond that the profession as a whole.

The audition will comprise:

- For performers: an individual performance consisting of two contrasting pieces, followed by a discussion about the music performed
- In all cases: a 1-2-1 discussion about your personal statement and your career aspirations.

LIFE AT RESONANCE



THE CAMPUS

Resonance is based at Cable Plaza, part of the spectacular Waterfront complex in Brierley Hill, West Midlands, just over half an hour from Birmingham.

Brierley Hill is right at the heart of the Black Country, home to some of the most iconic musical legends of the last 50 years or so.

Resonance builds on this heritage and offers students one of the most progressive and well-equipped music campuses currently available in the UK Higher Education sector.

Facilities include:

- Three state-of-the-art recording and production studios
- Radio station hosting Black Country Radio
- Rehearsal rooms, practice and meeting rooms
- Lecture theatre, teaching rooms and music technology suites
- Listening room, video production and green screen suite
- Café, library/resource centre and chill-out zone

Take a look at <https://www.resonance-edu.org/campus/> to find out more.

COMMUNITY

Resonance is looking forward to leading an ambitious community programme at Cable Plaza, giving people of all ages the opportunity to meet, learn, enjoy, share and be inspired by music.

This will include open days, events and short courses, some of which will be delivered by Resonance students under the supervision of their tutors. We'll also be working with Dudley Performing Arts, Black Country Radio, Dudley Council, the Brierley Hill Community Forum, local schools and colleges, the youth service, local charities and businesses.

There will be something for everyone, with music therapy, kindermusik for toddlers, music and wellbeing, a Saturday Music School, adults-only Weekend Warriors and more.



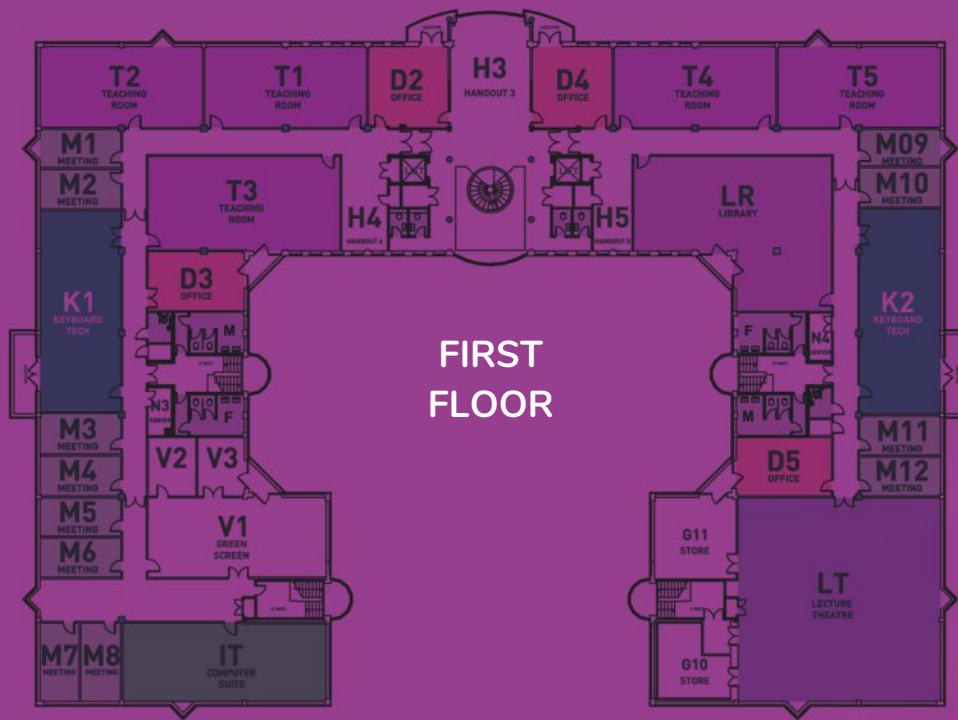

WHERE TO LIVE

The Resonance Housing Scheme is run in association with Your Move, Student Spareroom and Dudley Council to offer high quality, affordable accommodation to students who are not living at home.

You'll have several options, including your own room in a family home, sharing a house or your own studio flat – all within a 45-minute walk of Cable Plaza and with an average cost of between £345 and £450 per month.

SUPPORT

All students at Resonance can count on the best possible educational experience during your time here.

Your wellbeing is of prime importance to us, and we have a number of policies covering funding, careers and employability, chaplaincy, counselling, student affairs, key academic skills, disability support and general advice.

Further details will be available in your Student Handbook.

UNION MEMBERSHIP

As well as membership of the National Union of Students, we will support Resonance students who wish to be registered as a student member of both the Musicians Union and BECTU, the UK's leading media and entertainment union.



EQUALITY AND DIVERSITY

Resonance is committed to providing an environment free from discrimination, bullying, harassment or victimisation, and where all students and staff are treated with respect and dignity.

Our aim is to create a community culture, celebrating diversity and individuality, where everyone is valued for their contribution.

DISABILITY AND ACCESSIBILITY

We welcome applications from disabled students and will make reasonable adjustments to facilitate your access. This includes offering advice on, and support with, travel, physical access, special equipment and so on.

Please tell us about your requirements on your application form, so that we can discuss your needs from the outset.

ENGLISH LANGUAGE

Applicants who do not have English as their first language will be required to demonstrate an approved level of proficiency in the use of English language. The minimum requirements for study at Resonance are:

- IELTS 5.5 overall with a minimum of 5.0 in each component
- TOEFL IBT 71 with a minimum of 19 in each individual component – TOEFL is only valid for EU students or equivalent

Qualifications are checked before enrolment.

PERSONALISED OPEN DAYS





If you haven't seen Resonance in real life, now's your chance. Our personalised open days are a great way to understand what makes Resonance different from other providers and gives you an opportunity to see our amazing facilities and people.

Our personalised open days are **by appointment only**. Your visit will last approximately 45 minutes and you'll be shown round by one of our directors or course leaders.

Because the visit is tailored to you, it will be much more revealing and informative than a normal uni open day. You'll have plenty of chances to ask questions as you go round. You'll find out everything you want to know, and we'll be able to get to know you better too.

To arrange a personal open day, **you must book in advance**. Fill in the form available on the Resonance website and we'll be in touch to arrange a convenient date. If you'd prefer to opt for a **virtual open day**, please let us know and we'll sort out a one-to-one video call on Zoom instead.

We can't wait to meet you!

WHO'S BEHIND RESONANCE?

Resonance is grateful for the support and expertise of our Board of Trustees, partners and associates, who have played a vital role in shaping our pioneering programme.

SUPPORTED BY



PARTNERS

SOLENT
UNIVERSITY
SOUTHAMPTON

TotalSolutions
Group

**Musicians'
Union**
mu

mia
music industries association

plasa

dpa
dudley performing arts

**BLACK
COUNTRY RADIO**

SSE AUDIO GROUP

Marshall

NATAL

M2
STUDIOS

Roland

Focusrite®

BOSS

steinberg

**CREATIVE
TECHNOLOGY**
NEP Live Events

SENNHEISER



Resonance
Cable Plaza
Waterfront West
Brierley Hill
West Midlands
DY5 1LW

Should you have any questions please email

admissions@resonance-edu.org

or call

0300 555 1800

For more detailed information please visit our website

www.resonance-edu.org

